

# Egress Windows

At least 1 egress window (or exterior door) is required to be provided in sleeping rooms, below the fourth story to be considered an egress window, all of the following 4 conditions must be met.

Double hung windows

Casement Windows

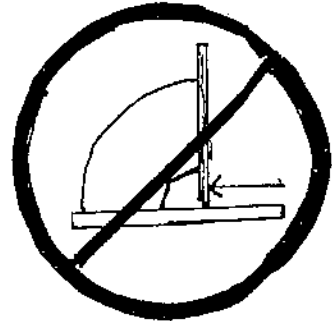
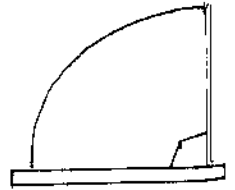
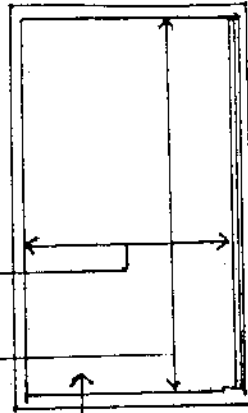
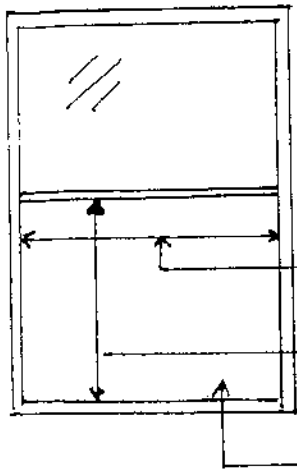

- 1 minimum width 20"
- 2 minimum height 24"
- 3 Total net clear opening must be a minimum of:  
5.7 square feet or 821 square inches

**Caution** . . . A window which may meet the minimum opening width & height requirements (of condition 1 & 2) does not qualify as an egress window unless it also meets the total square foot opening requirement. (condition #3)

- 4 Lowest point of the opening must not be more than 44 inches above the floor

